

# Artemide®

## Reall

design  
C. de Bevilacqua  
P. Dell'Elce

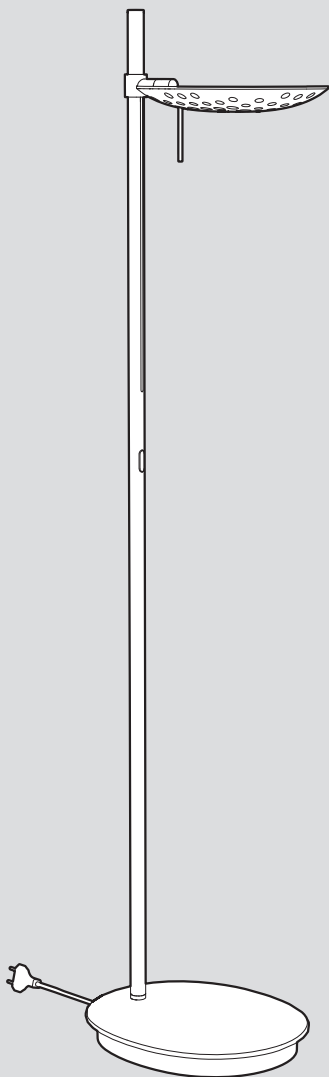



i

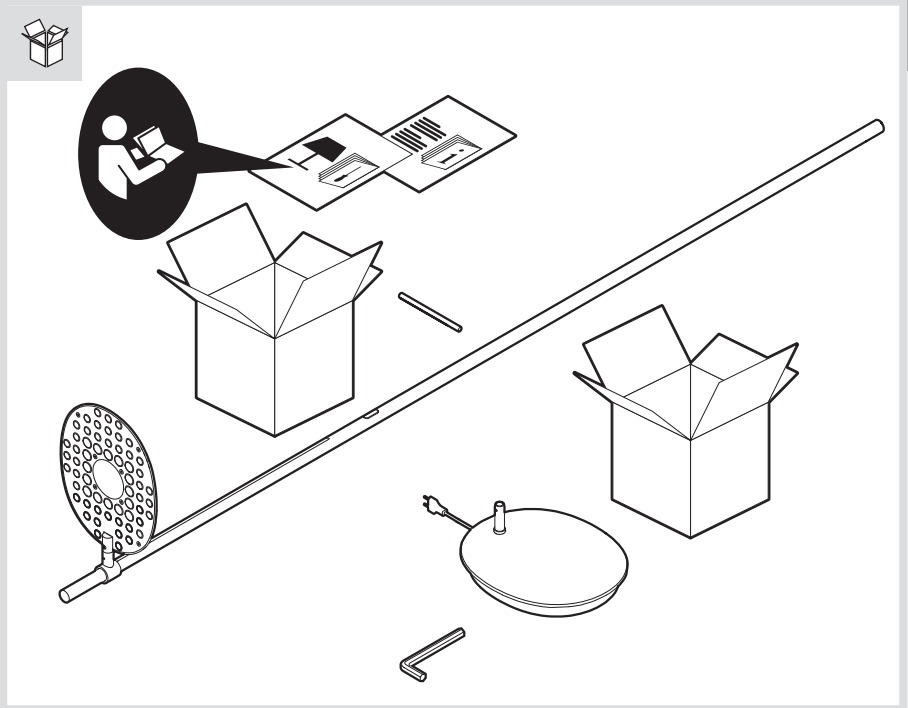
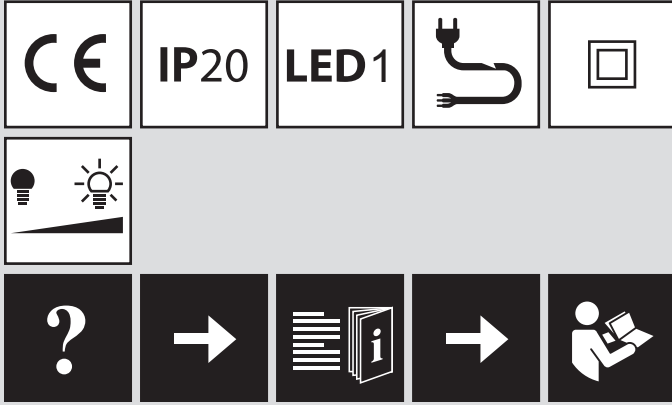

1

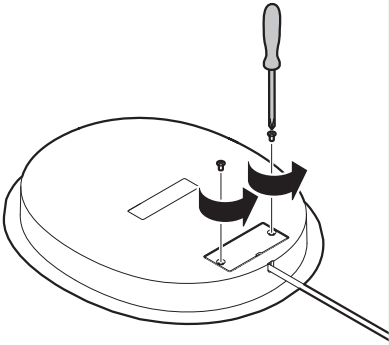

2

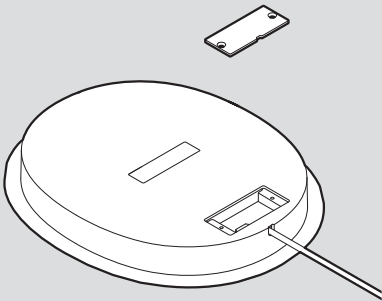
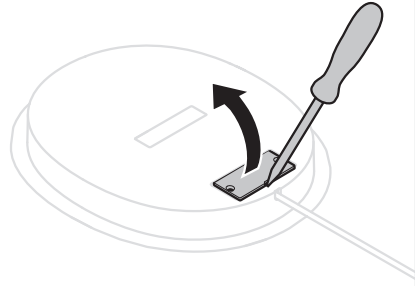

3

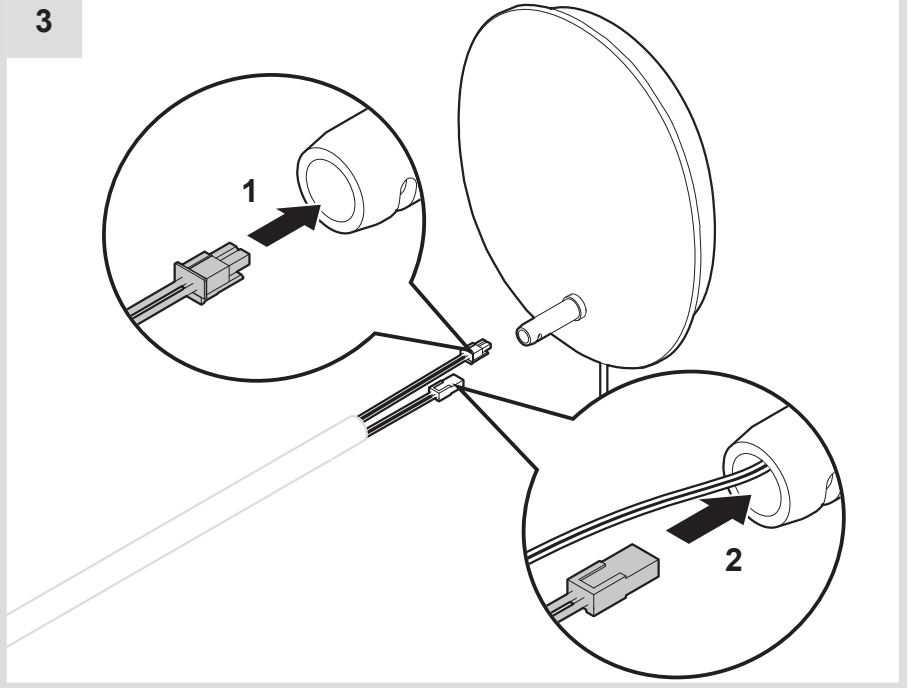

4

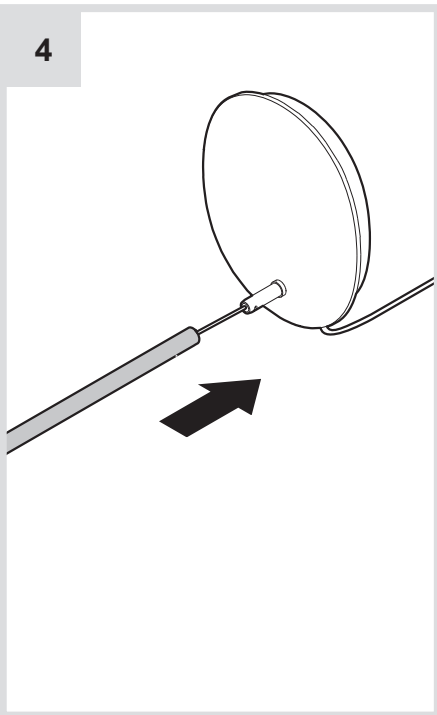

5

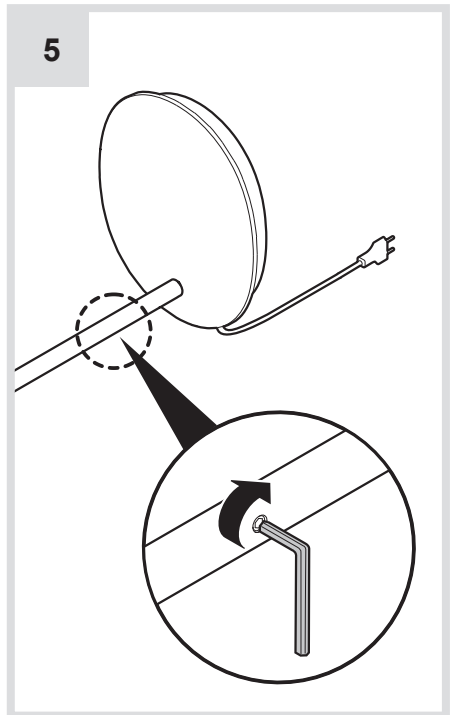

6

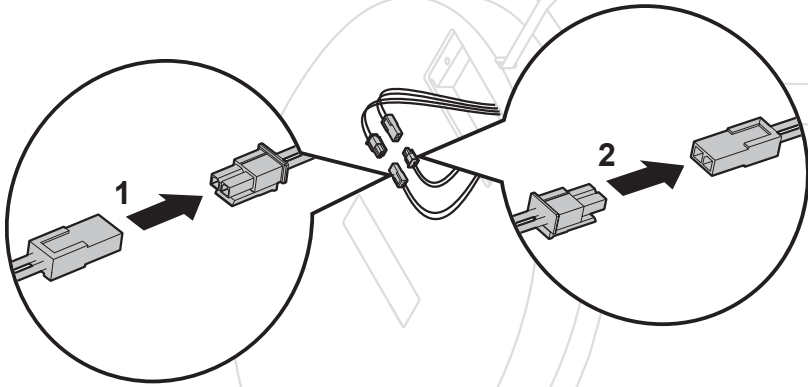

7

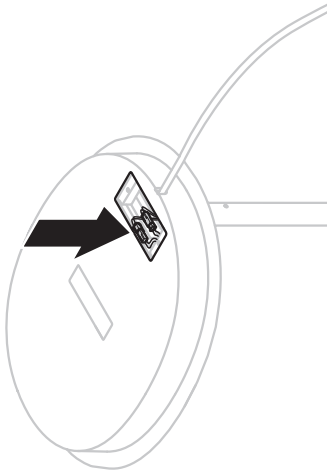

8

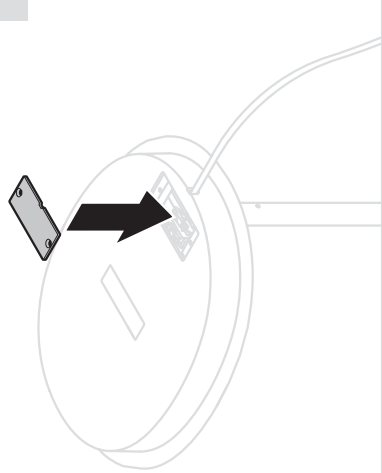

9

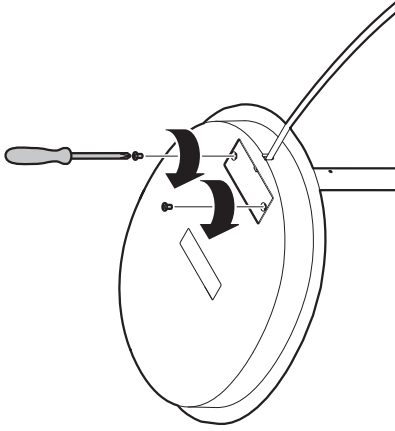

10

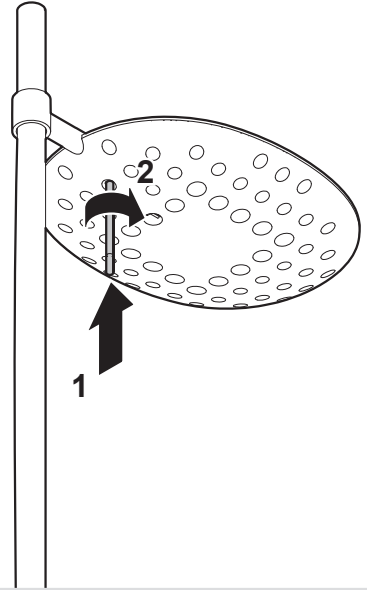

**i**

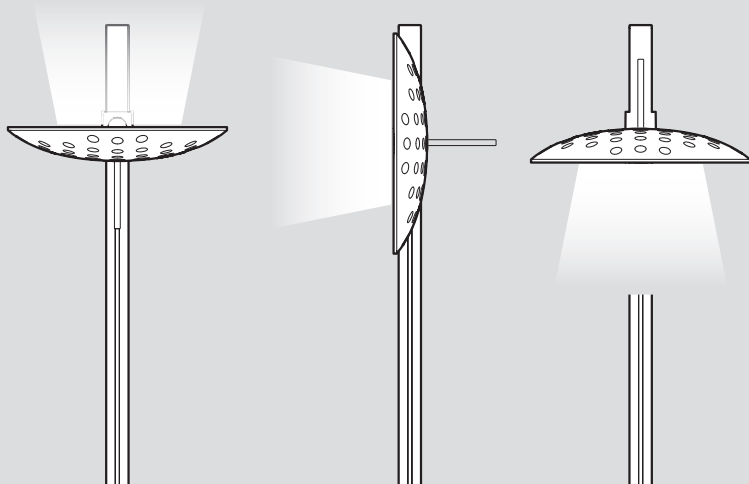

**1**

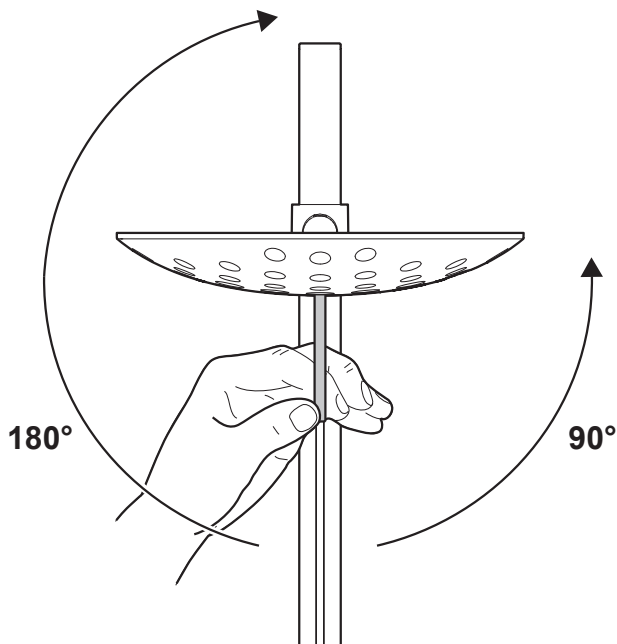



1

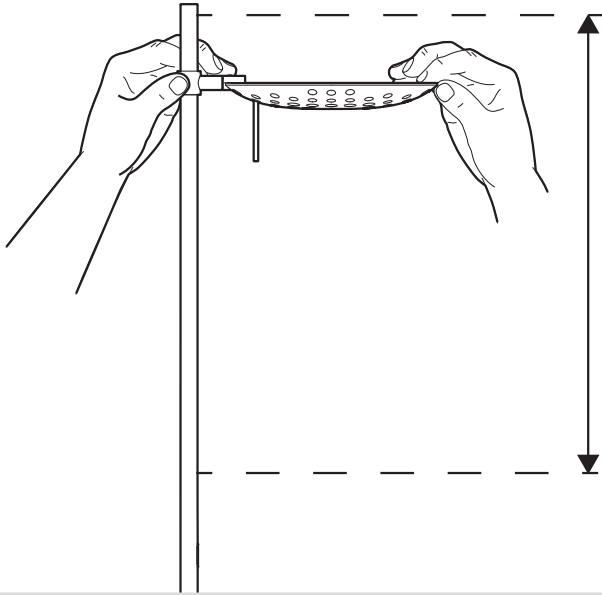



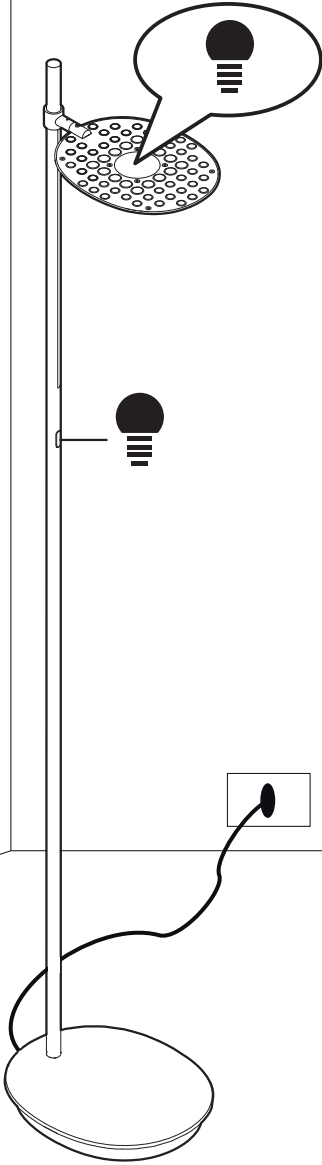

**i**

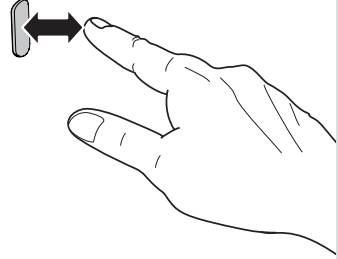
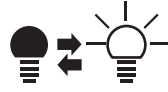

**i**

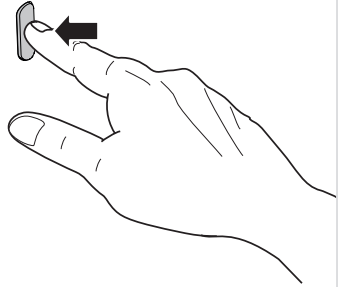
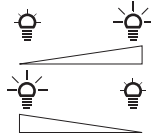

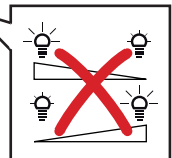
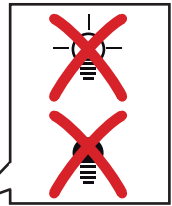
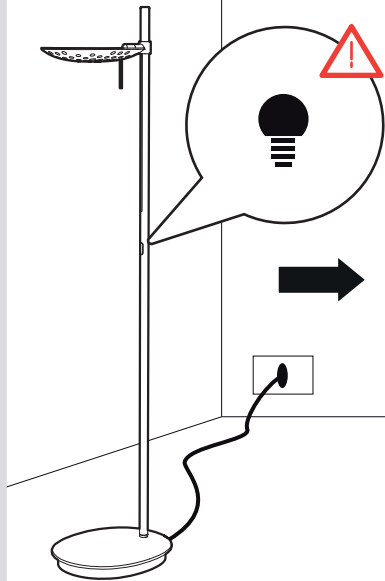
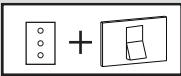
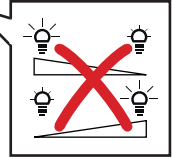
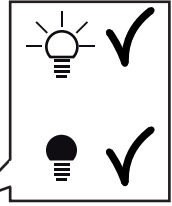
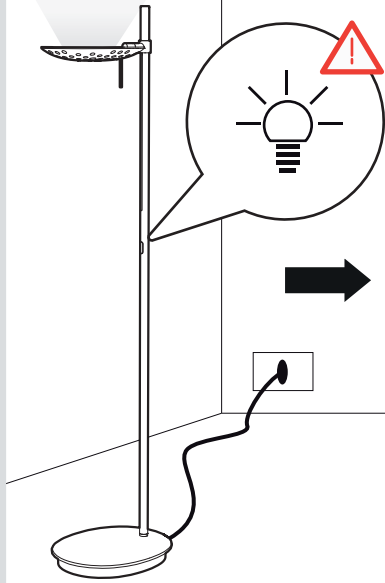
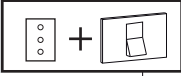

i

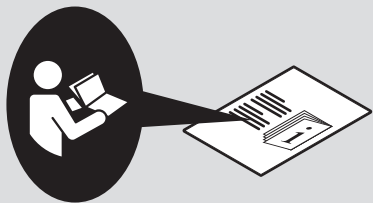

1

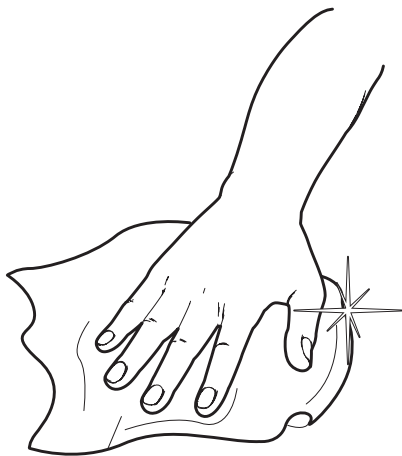

**Artemide®**



**Artemide**

via Bergamo, 18  
20010 Pregnana M.se (MI)  
ITALIA

tel. +39 02 935 181  
fax +39 02 935 90 254  
fax +39 02 935 90 496

[www.artemide.com](http://www.artemide.com)

VAT IT00846890150

cod. Y513000132B